

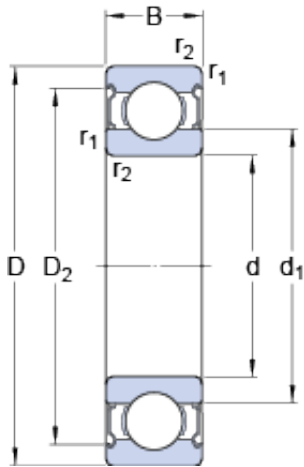

# AF Bearing Machinery Co., Ltd.



D/W R1-2Z Bearing 2D drawings and 3D CAD models

## SKF D/W R1-2Z deep groove ball bearings

Bearing No. D/W R1-2Z

Size	4.762x1.397x2.779 mm
Bore Diameter	4,762 mm
Outer Diameter	1,397 mm
Width	2,779 mm
d	1.397 mm
D	4.762 mm
B	2.779 mm
d <sub>1</sub>	2.33 mm
D <sub>2</sub>	4.25 mm
r <sub>1,2</sub> - min.	0.1 mm
d <sub>a</sub> - min.	2.2 mm
D <sub>a</sub> - max.	4.3 mm
r <sub>a</sub> - max.	0.1 mm
Basic dynamic load rating - C	0.133 kN
Basic static load rating - C <sub>0</sub>	0.034 kN
Fatigue load limit - P <sub>u</sub>	0.001 kN
Reference speed	200000 r/min
Limiting speed	100000 r/min
Calculation factor - k <sub>r</sub>	0.03
Calculation factor - f <sub>0</sub>	5.7
d <sub>1</sub>	2.33 mm
D <sub>2</sub>	4.25 mm
r <sub>1,2</sub> min.	0.1 mm
d <sub>a</sub> min.	2 mm
d <sub>a</sub> max.	2.2 mm



## AF Bearing Machinery Co., Ltd.

$D_a$ max.	4.3 mm
$r_a$ max.	0.1 mm
Basic dynamic load rating C	0.133 kN
Basic static load rating $C_0$	0.034 kN
Fatigue load limit $P_u$	0.001 kN
Calculation factor $k_r$	0.03
Calculation factor $f_0$	5.7
Mass bearing	0.0002 kg